

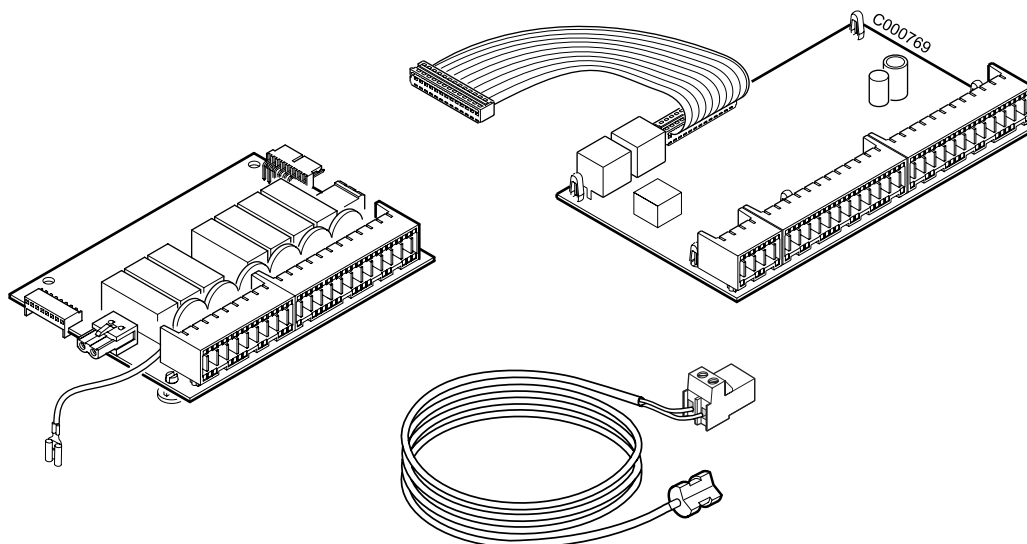



AD220

1 Presentation



In the context of a cascade installation, the relay + sensor PCB option is used to connect the first circuit with mixing valve to a boiler fitted with a **K3** control panel.

2 Important recommendations

-  Only qualified professionals may carry out electrical connections, always with the power off.
-  As the electrical wiring has been carefully checked in the factory, the internal connections on the control panel must not be changed in any way.
-  Electrical connections must match the electrical diagrams delivered with the equipment and comply with the instructions in the manual.

3 Fitting the PCB AD220

GT 330 / GT 430 / GT 530

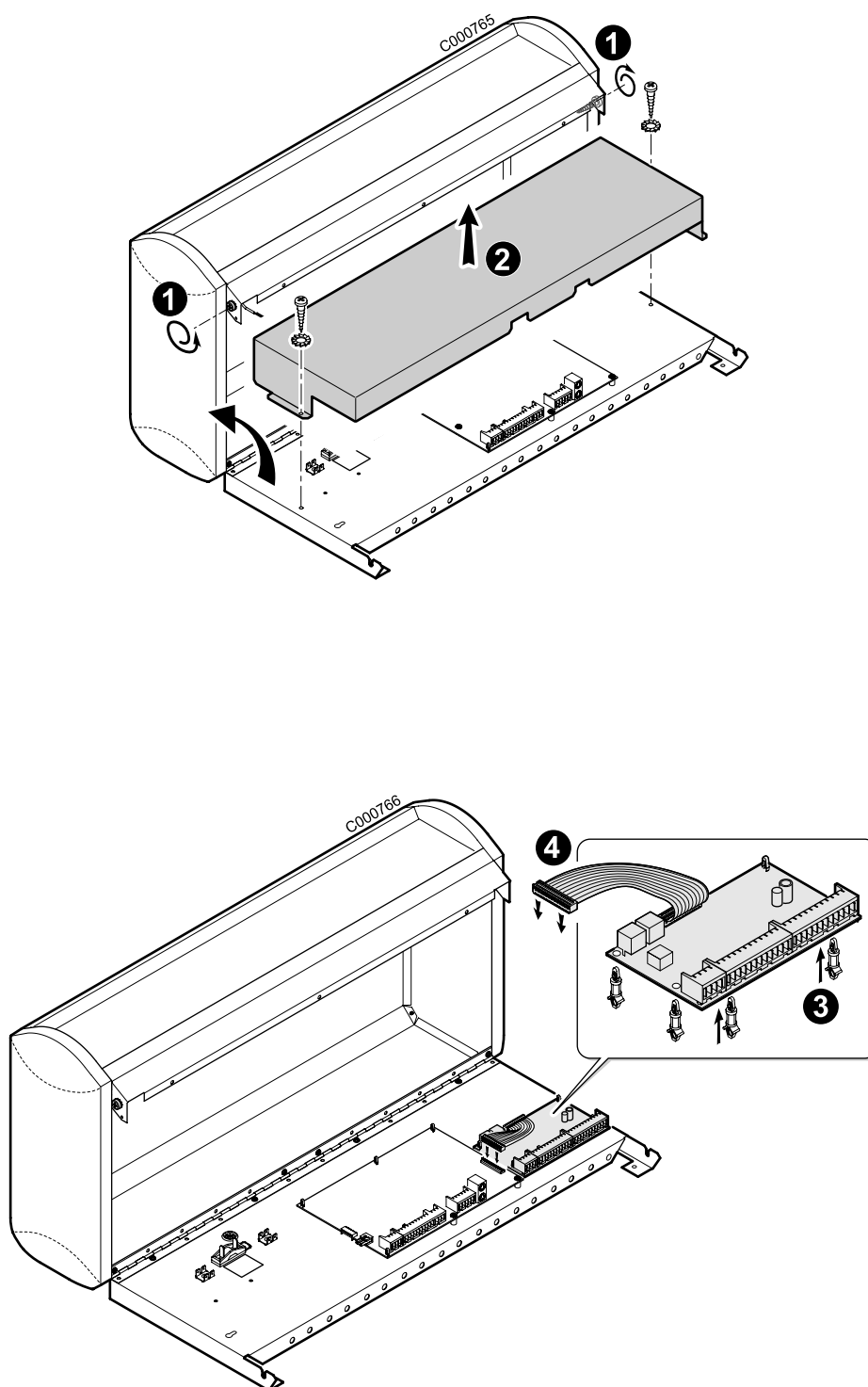

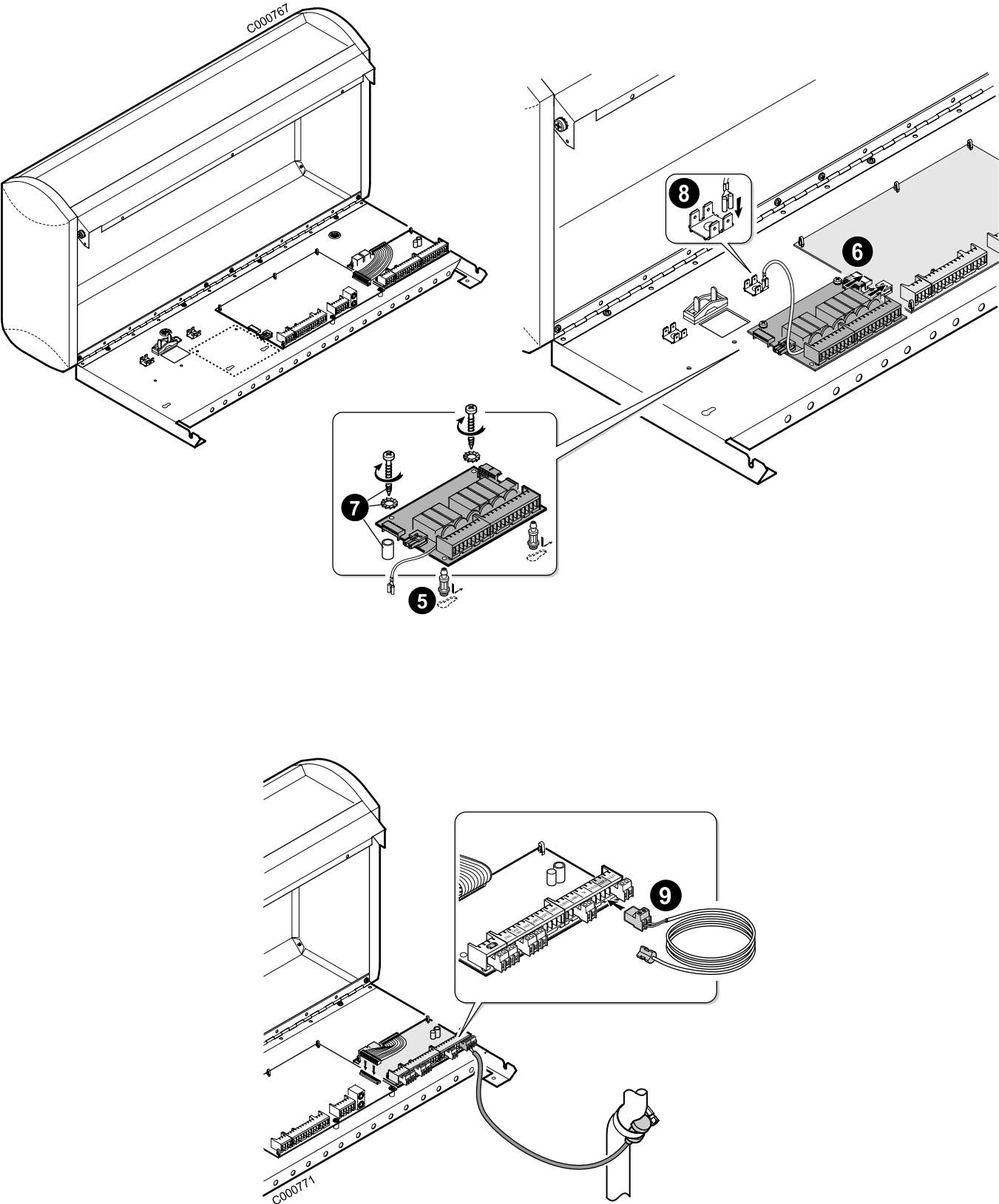

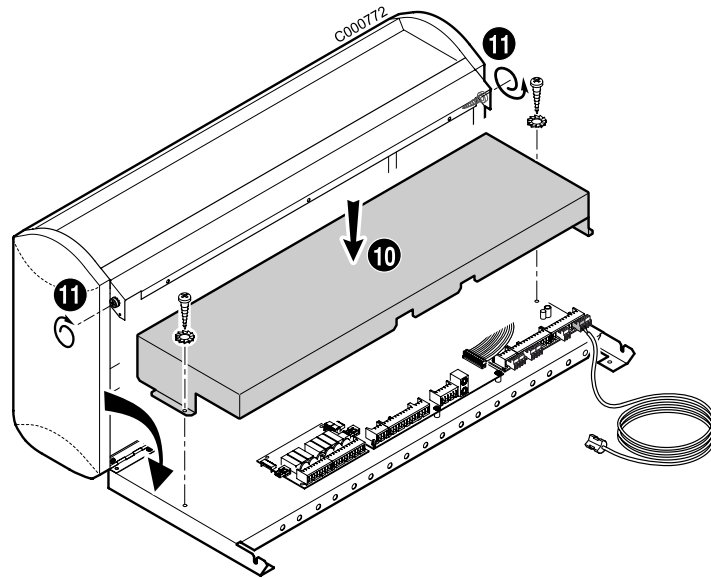

DTG 230 / DTG 330

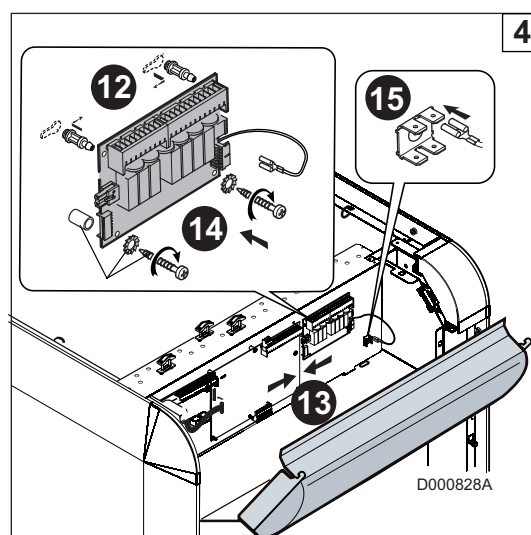
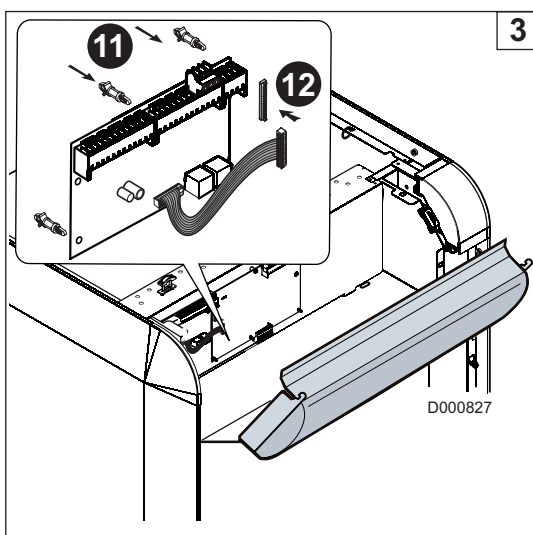
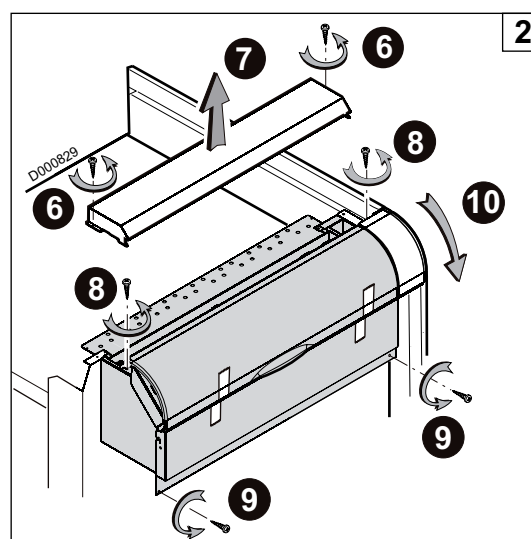
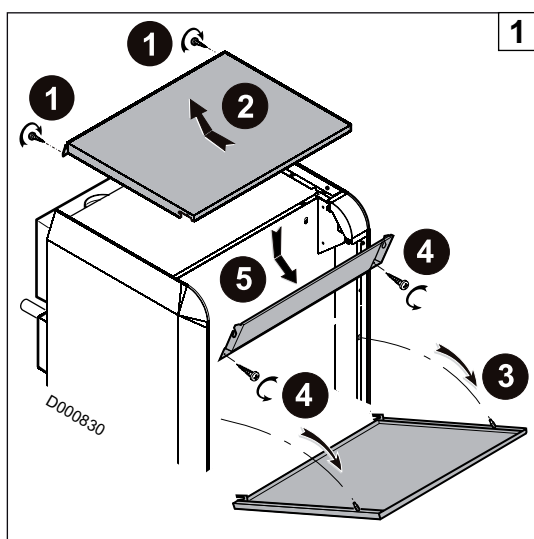

► To re-assemble, proceed in reverse order.

CA 430 / CA 530

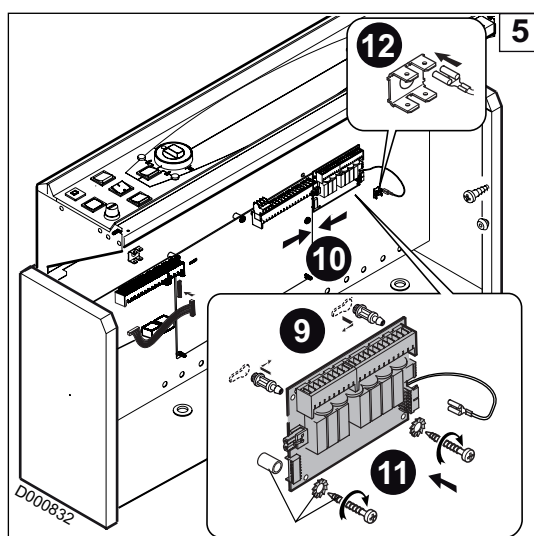
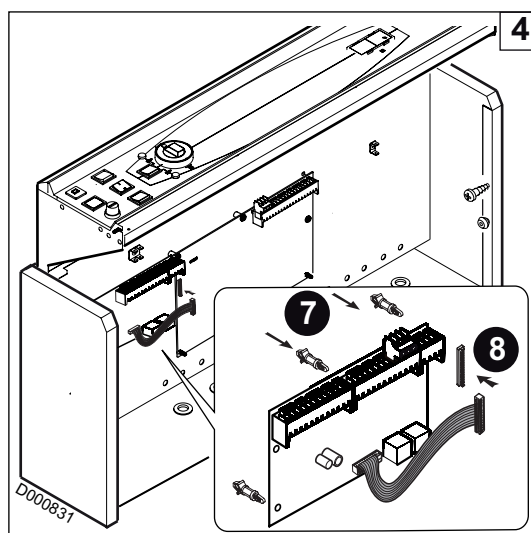
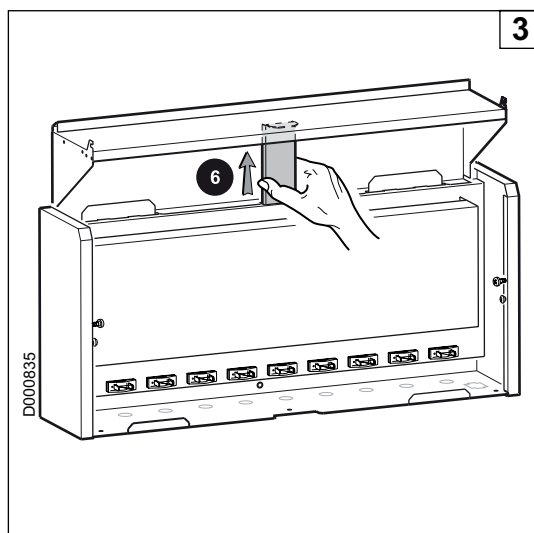
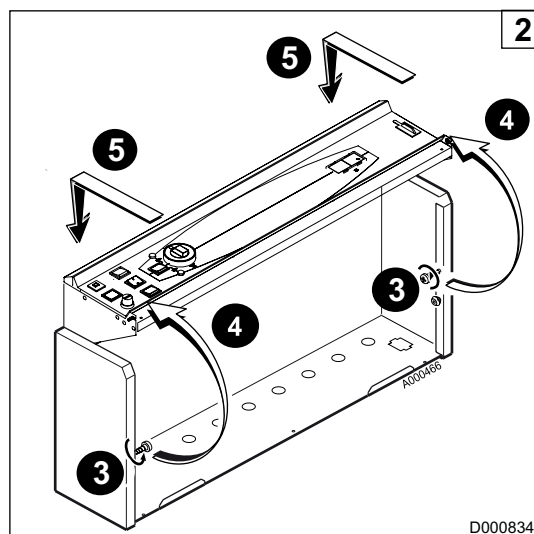
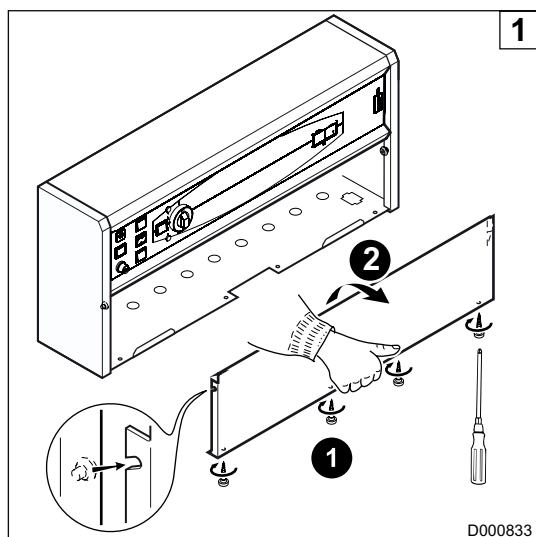

► To re-assemble, proceed in reverse order.

4 Example of an installation

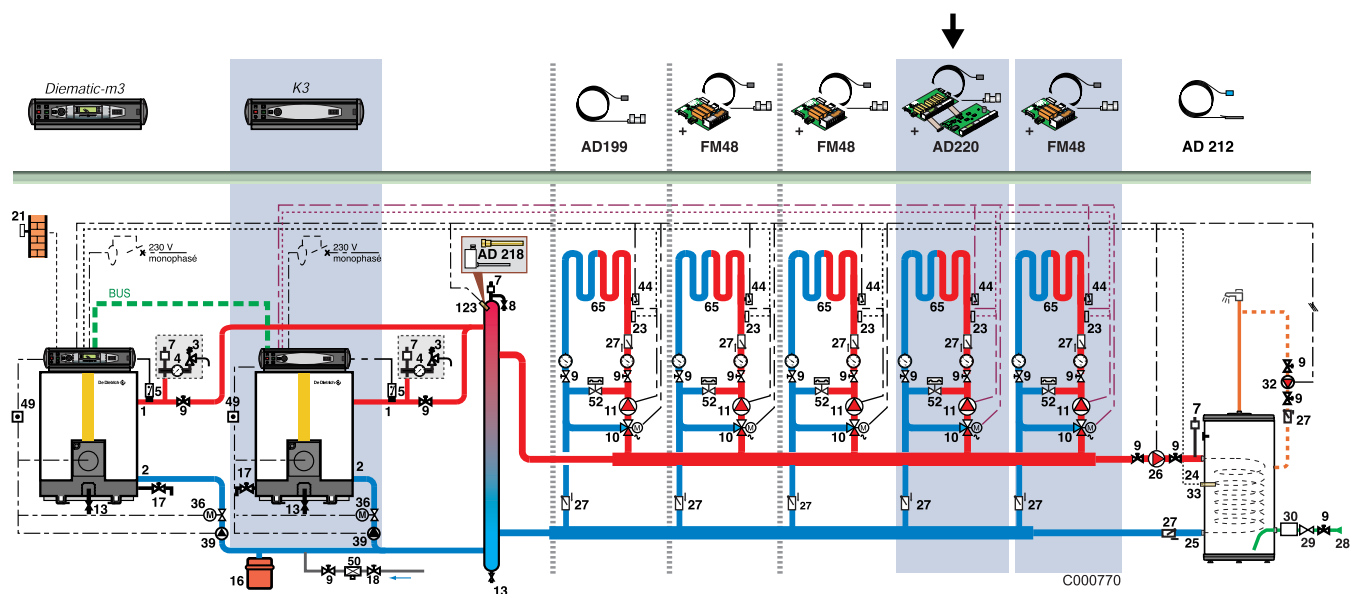

- 1 Heating outlet
- 2 Heating return
- 3 3-bar safety valve
- 4 Pressure gauge
- 5 Flow controller
- 7 Automatic air vent
- 8 Manual bleed valve
- 9 Valve
- 10 3-way mixing valve
- 11 Heating pump
- 13 Flush valve
- 16 Expansion vessel
- 17 Draining valve
- 18 Filling the heating circuit
- 21 Exterior temperature sensor
- 23 Mixing valve outlet temperature sensor
- 24 DHW tank heat exchanger primary inlet
- 25 DHW tank heat exchanger primary outlet
- 26 DHW load pump
- 27 one-way valve
- 28 Domestic cold water inlet
- 29 Pressure reducer
- 30 Sealed safety unit calibrated to 7 bar
- 32 Domestic hot water loop pump (optional)
- 33 Domestic hot water temperature sensor
- 36 Motorised gate valve
- 39 Injection pump
- 44 Thermostat limiting the temperature to 65°C with manual reset for underfloor heating (France: DTU 65.8, NF P 52-303-1)
- 50 Disconnector
- 52 Differential valve
- 65 Low temperature circuit (radiators or underfloor heating)
- 123 Cascade outlet sensor

DE DIETRICH THERMIQUE S.A.S.

www.dedietrich-thermique.fr



Direction des Ventes France
57, rue de la Gare
F- 67580 MERTZWILLER
☎ +33 (0)3 88 80 27 00
✉ +33 (0)3 88 80 27 99

ÖAG AG

www.oeag.at



Schemmerlstrasse 66-70
A-1110 WIEN
☎ +43 (0)50406 - 61624
✉ +43 (0)50406 - 61569
dedietrich@oeag.at

DE DIETRICH REMEHA GmbH

www.dedietrich-remeha.de



Rheiner Strasse 151
D- 48282 EMSDETTEN
☎ +49 (0)25 72 / 23-5
✉ +49 (0)25 72 / 23-102
info@dedietrich.de

NEUBERG S.A.

www.dedietrich-heating.com



39 rue Jacques Stas
L- 2010 LUXEMBOURG
☎ +352 (0)2 401 401

VAN MARCKE

www.vanmarcke.be



Weggevoerdenlaan 5
B- 8500 KORTRIJK
☎ +32 (0)56/23 75 11

DE DIETRICH

www.dedietrich-otoplenie.ru



8 Gilyarovskogo Str. 7
R- 129090 MOSCOW
☎ +7 495.974.16.03
✉ +7 495.974.66.08
dedietrich@nnt.ru

WALTER MEIER (Klima Schweiz) AG

www.waltermeier.com



Bahnstrasse 24
CH-8603 SCHWYZENBACH
☎ +41 (0) 44 806 44 24
Serviceline +41 (0)8 00 846 846
✉ +41 (0) 44 806 44 25
ch.klima@waltermeier.com

WALTER MEIER (Climat Suisse) SA

www.waltermeier.com

Z.I. de la Veyre B, St-Légier
CH-1800 VEVEY 1
☎ +41 (0) 21 943 02 22
Serviceline +41 (0)8 00 846 846
✉ +41 (0) 21 943 02 33
ch.climat@waltermeier.com

DE DIETRICH

www.dedietrich-heating.com



Room 512, Tower A, Kelun Building
12A Guanghua Rd, Chaoyang District
C-100020 BEIJING
☎ +86 (0)106.581.4017
+86 (0)106.581.4018
+86 (0)106.581.7056
✉ +86 (0)106.581.4019
contactBJ@dedietrich.com.cn

AD001-AA

© Copyright

All technical and technological information contained in these technical instructions, as well as any drawings and technical descriptions supplied, remain our property and shall not be multiplied without our prior consent in writing.

Subject to alterations.

16/09/08



300010330-001-C

De Dietrich



DE DIETRICH THERMIQUE
57, rue de la Gare F- 67580 MERTZWILLER - BP 30