

MISIŅA CW 617 N / UNI EN 12165 ŠĻŪTENES SAVIENOTĀJS, TIPS "EXCELSIOR"

DEKRĒTA LIKUMS 25/02/2000 Nr.93, izstrādājums, kas uzrādīts šajā tehniskajā lapā, izstrādāts saskaņā ar PED 97/23/CE zīmi, saskaņā ar 3. par. 3 daļu.



850



851



852

GALVENIE IZMĒRI

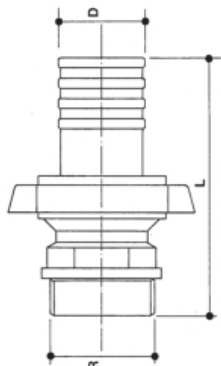

R"	X	D	L
3/8	15	15	58
1/2	15	15	58
1/2	18	18	65
1/2	20	20	65
3/4	20	20	67
3/4	25	25	79
1	25	25	82
1	30	30	92
1	32	32	95
1¼	30	30	93
1¼	32	32	95
1¼	35	35	103
1½	40	40	105
2	50	50	125
2	60	60	140
2½	60	60	135
-	-	-	-
-	-	-	-

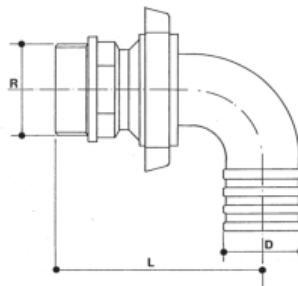

R"	X	D	L
3/8	15	15	52
1/2	15	15	55
1/2	18	18	60
1/2	20	20	60
3/4	20	20	60
3/4	25	25	70
1	25	25	75
1	30	30	85
1¼	30	30	85
1¼	35	35	95
1½	40	40	100
2	50	50	115
2	60	60	130
2½	60	60	125
-	-	-	-

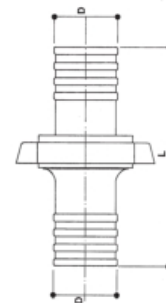

D	X	D	L
15	15	15	65
18	18	18	72
20	20	20	72
25	25	25	88
30	30	30	102
35	35	35	116
40	40	40	121
-	-	-	-

RACCORDI "EXCELSIOR" IN OTTONE CW 617 N / UNI EN 12165 A SEDE METALLICA
BRASS CW 617 N / UNI EN 12165 COUPLINGS "EXCELSIOR" WITH METAL SEAT

DECRETO LEGISLATIVO 25/02/2000 N° 93
il prodotto illustrato nella presente scheda tecnica soddisfa i requisiti della direttiva PED 97/23/CE ed e' esentato dalla marcatura CE in base all'art.3 par. 3.

DECREE LAW DD. 25/02/2000 NO.93
the product showed in this technical sheet is made according to PED 97/23/CE and it is CE marking-free as per art. 3 par.3.

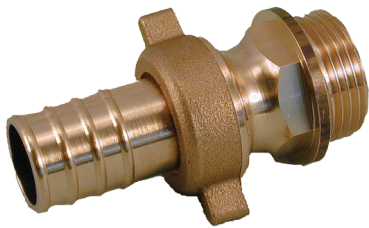

850



851



852

DIMENSIONI PRINCIPALI

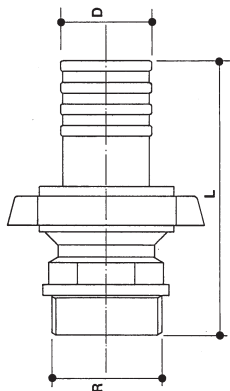

R"	X	D	L
3/8	15	58	
1/2	15	58	
1/2	18	65	
1/2	20	65	
3/4	20	67	
3/4	25	79	
1	25	82	
1	30	92	
1	32	95	
1 1/4	30	93	
1 1/4	32	95	
1 1/4	35	103	
1 1/2	40	105	
2	50	125	
2	60	140	
2 1/2	60	135	
-	-	-	
-	-	-	

LEADING DIMENSIONS

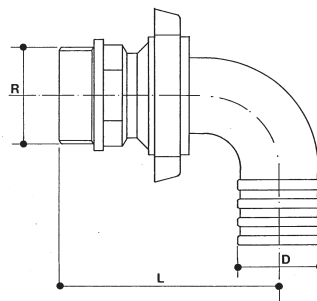

R"	X	D	L
3/8	15	52	
1/2	15	55	
1/2	18	60	
1/2	20	60	
3/4	20	60	
3/4	25	70	
1	25	75	
1	30	85	
1 1/4	30	85	
1 1/4	35	95	
1 1/2	40	100	
2	50	115	
2	60	130	
2 1/2	60	125	
-	-	-	

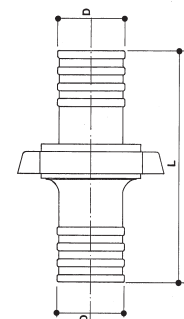

D	X	D	L
15	15	65	
18	18	72	
20	20	72	
25	25	88	
30	30	102	
35	35	116	
40	40	121	
-	-	-	