

# SPINDLE EXTENSIONS series TV, FV



## TECHNICAL CHARACTERISTICS

Stem from zinc coated steel  
 HDPE plastic cover  
 Top and bottom caps are powder epoxy coated with 250 µm thickness

# STREET BOX



## TECHNICAL CHARACTERISTICS

Body from ductile iron EN-GJL-200  
 Anticorrosion painting  
 Zinc coated bolt holds the cover in place (4050 version)



OTHER PRODUCTS

DN	SQ	Lmin	Lmax	BLUCAST ref. no.
	10,5	1300	1800	TV1318SQ10
20-50	12	1300	1800	TV1318SQ12
20-50	14	1300	1800	TV1318SQ14
65-80	17	1300	1800	TV1318SQ17
100-150	19	1300	1800	TV1318SQ19
200	24	1300	1800	TV1318SQ24
250-400	27	1300	1800	TV1318SQ27
500-600	32	1300	1800	TV1318SQ32
	10,5	2000	2500	TV2025SQ10
20-50	12	2000	2500	TV2025SQ12
20-50	14	2000	2500	TV2025SQ14
65-80	17	2000	2500	TV2025SQ17
100-150	19	2000	2500	TV2025SQ19
200	24	2000	2500	TV2025SQ24
250-400	27	2000	2500	TV2025SQ27
500-600	32	2000	2500	TV2025SQ32
25-600	10,5-32	600	600	FV06SQ/...
25-600	10,5-32	1000	1000	FV10SQ/...
25-600	10,5-32	1500	1500	FV15SQ/...
25-600	10,5-32	2000	2000	FV20SQ/...

	L	d	weight	BLUCAST ref. no.
<b>small</b>	150	110	2,9	4050
<b>big</b>	270	185	11	4056

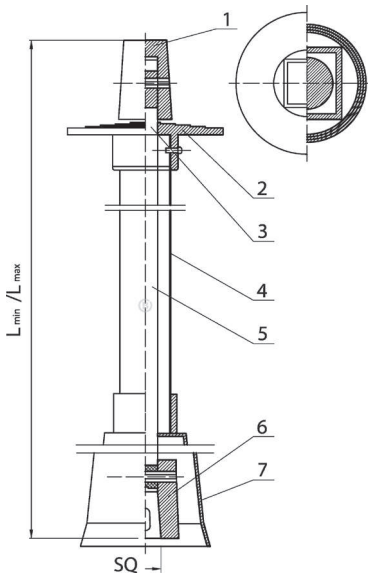

No.	Item	Material
1	Top cap	EN-GJL-250
2	Flange	HDPE
3	Connector	Galvanized steel
4	Cover	HDPE
5	Telescopic spindle	Galvanized steel
6	Bottom cap	EN-GJL-250
7	Bell	HDPE

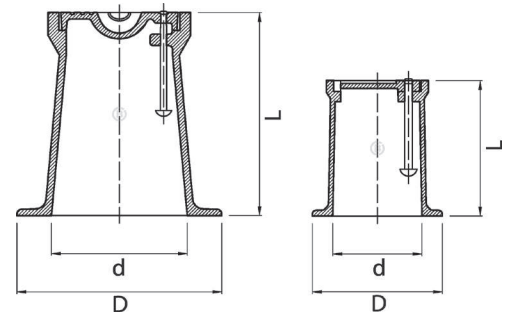

All illustrations, technical data, dimensions (in mm) and weights (all weights specified in kg) are non-binding and are subject to change

