

ALL FLANGED CROSS series TT



TECHNICAL CHARACTERISTICS

Flange end connections according to EN1092-2
 Drilling of flanges: PN10/16, starting from DN200 - PN10
 Designed according to EN545
 Maximum working pressure: PN16 / 16 bar
 Working temperature: 0°C - +70°C
 Color RAL5015
 Powder epoxy coating 250 µm thickness
 Body from ductile iron EN-GJS-500-7
 WRAS approved epoxy coating,
 ACS approved epoxy coating under request



DUCTILE IRON FITTINGS

DN1	DN2	L	H1	H2	Weight	BLUCAST ref. no.
50	50	300	150	150	14	TT050
65	65	330	165	165	17.5	TT065
80	80	330	165	165	20.1	TT080
100	50	330	165	165	21.5	TT100050
100	80	360	175	175	23	TT100080
100	100	360	180	180	25	TT100100
150	80	440	205	205	33.1	TT150080
150	100	440	210	210	35.1	TT150100
150	150	440	220	220	41.1	TT150
200	100	520	240	240	48.5	TT200100
200	150	520	250	250	54.5	TT200150
200	200	520	260	260	61.5	TT200
200	200	520	260	260	60.9	TTP200
250	100	700	275	275	74.1	TT250100
250	250	700	350	350	102	TT250
300	100	800	300	300	100	TT300100
300	150	800	325	325	108	TT300150
300	200	800	350	350	116	TT300200
300	300	800	400	400	144	TT300
350	350	850	425	425	174	TT350
400	100	900	350	350	149	TT400100
400	150	900	350	350	151	TT400150
400	400	900	450	450	211	TT400
500	500	1000	500	500	299	TT500
600	600	1100	550	550	416	TT600

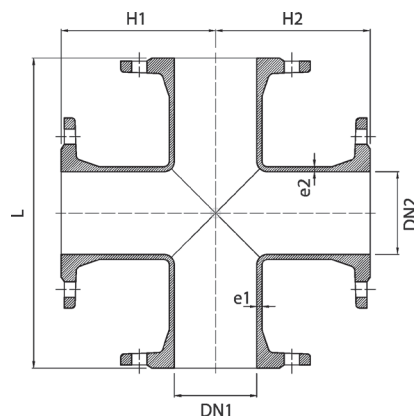

All illustrations, technical data, dimensions (in mm) and weights (all weights specified in kg) are non-binding and are subject to change

