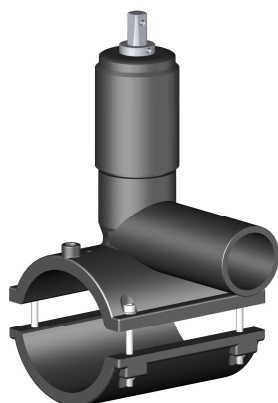
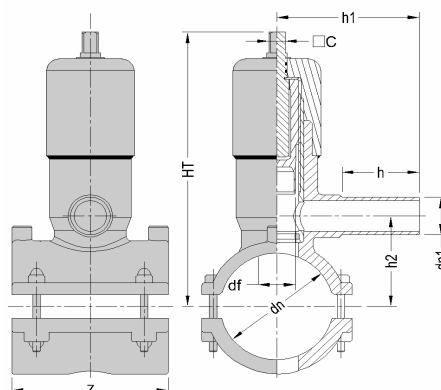

PRODUCT DETAILS

DIMENSIONS AND WEIGHT

ITEM	2173161163
dn [mm]	110
dn1 [mm]	63
SDR	11
PN	16
MATERIAL	PE100
TRADEMARK	EURO
MANUFACTURING TYPE	INJECTION MOULDED
USE	WATER-GAS
QUANTITY PER BOX	1

NOTE:

dn	[mm]	110	df	[mm]	30
dn1	[mm]	63			
h	[mm]	83			
h1	[mm]	147			
h2	[mm]	69			
HT	[mm]	278			
Z	[mm]	160	WEIGHT	[g]	2600

Tolerance: +/- 5% excluding dn dn1

STANDARDS AND APPROVALS

EN 12201
EN 1555
ISO 15494

MARKING AND LABEL on fitting

PE100 d110x63 SDR11 PN16

WELDING INFORMATION

RESISTANCE [Ohm]	0,96
VOLTAGE [V]	20
FUSION TIME [sec]	225
COOLING TIME [min]	20

Weldability barcode	05211815-110-8-20-096-6-225-74-6
CIRCUIT TYPE	SINGLE WIRE
CONNECTOR DIAMETER [mm]	4,0

WELDABILITY on pipe/fitting :

SDR 33	NO
SDR 26	NO
SDR 17	YES
SDR 11	YES
SDR 9	NO
SDR 7,4	NO

INFOS

- Boring after cooling is completed
- Suitable for application on pipelines under pressure gas and water
- ABSOLUTELY compulsory the pipe scraping in the welding zone
- Integrated closing valve
- Handling rod with square conical connection of 13/15 mm

All dimensions are in millimeters and are intended as nominal and standard sizes: weights are in grams.
EUROSTANDARD reserves the right to change geometries and dimensions of any product.