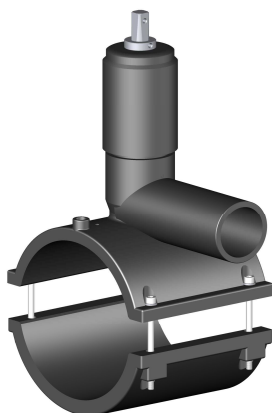
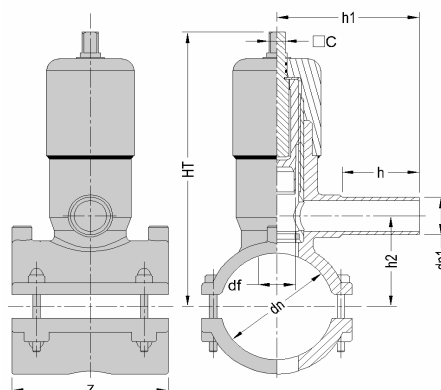

**PRODUCT DETAILS**

**DIMENSIONS AND WEIGHT**

ITEM	<b>2173161663</b>
dn [mm]	160
dn1 [mm]	63
SDR	11
PN	16
MATERIAL	PE100
TRADEMARK	EURO
MANUFACTURING TYPE	INJECTION MOULDED
USE	WATER-GAS
QUANTITY PER BOX	1

NOTE:

dn	[mm]	160	df	[mm]	30
dn1	[mm]	63			
h	[mm]	72			
h1	[mm]	147			
h2	[mm]	104			
HT	[mm]	303			
Z	[mm]	160	WEIGHT	[g]	3000

Tolerance: +/- 5% excluding dn dn1

**STANDARDS AND APPROVALS**

EN 12201  
EN 1555  
ISO 15494

**MARKING AND LABEL on fitting**

PE100 d160x63 SDR11 PN16

**WELDING INFORMATION**

RESISTANCE [Ohm]	0,96
VOLTAGE [V]	20
FUSION TIME [sec]	225
COOLING TIME [min]	20

Weldability barcode	05211815-160-8-20-096-6-225-74-1
CIRCUIT TYPE	SINGLE WIRE
CONNECTOR DIAMETER [mm]	4,0

**WELDABILITY on pipe/fitting :**

SDR 33	NO
SDR 26	NO
SDR 17	YES
SDR 11	YES
SDR 9	NO
SDR 7,4	NO

**INFOS**

- Boring after cooling is completed
- Suitable for application on pipelines under pressure gas and water
- ABSOLUTELY compulsory the pipe scraping in the welding zone
- Integrated closing valve
- Handling rod with square conical connection of 13/15 mm

All dimensions are in millimeters and are intended as nominal and standard sizes: weights are in grams.  
EUROSTANDARD reserves the right to change geometries and dimensions of any product.