

EUS-Series 50Hz Submersible Dewatering Pump



50EUS-5.05

50(80)EUS-5.10A

50EUS-5.20

EUS 50Hz

Feature

- > High abrasive resistance resin Vortex impeller
- > Double mechanical seal / Designed Agitator
- > Auto reset thermal protector / Non air locking
- > Auto version for small pit usage

Application

- > Residential, commercial, industrial dewatering and site drainage
- > Decorative waterfalls and fountains.
- > Raw water supply from lakes or rivers.
- > Sediment removal from small sumps of basins.

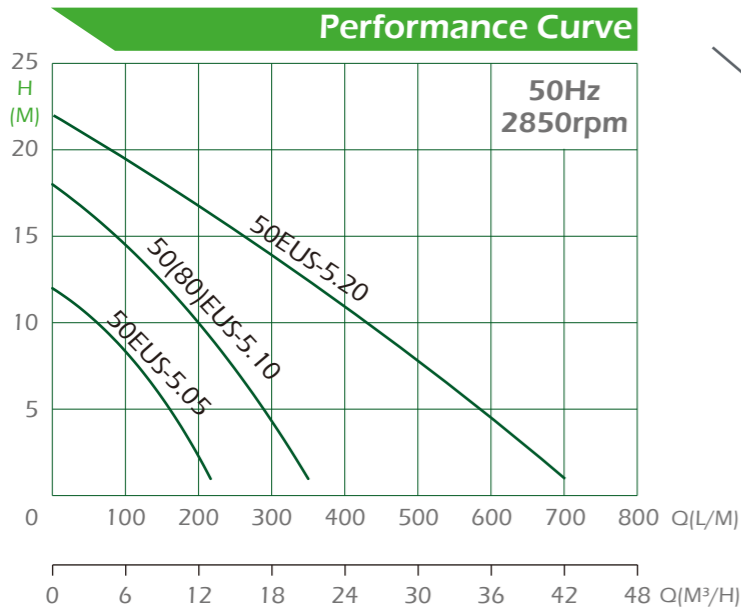

Agitator



Steel coated with thermoplastic polyester elastomer

Parts and Material List

No	Part	Mtrl
1	Handle	Nylon 6
2	Motor Cover	ADC 12
4	End Bracket	SECC
5	Shaft	SUS 410
6	Motor Housing	ADC 12
9	Mech. Seal	Upper : CA/CE Lower : SIC/SIC
10	Impeller	Hytrel
12	Pump Casing	FC 200
13	Agitator	SMF5030
16	Strainer	PVC

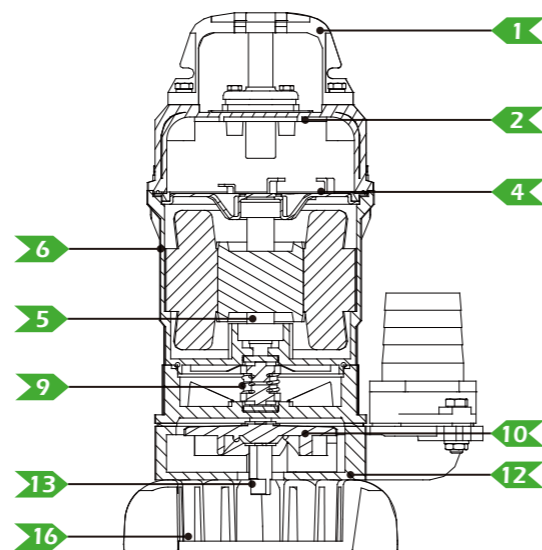

Specifications											
Type	Version	Output		Discharge		Rated		Maximum		Cable	Weight
		HP	W	mm	Inch	Head M	Capacity LPM	Head M	Capacity LPM	M	Kg
50EUS-5.05	Manual	0.5	400	50	2"	8	110	12	220	5	13
50EUS-5.05A	Auto	0.5	400	50	2"	8	110	12	220	5	13.3
50(80)EUS-5.10	Manual	1	750	50(80)	2"(3")	10	200	18	350	5	15.5
50(80)EUS-5.10A	Auto	1	750	50(80)	2"(3")	10	200	18	350	5	15.8
50(80)EUS-5.20	Manual	2	1500	50(80)	2"(3")	16	243	22	700	5	19.3
50(80)EUS-5.20A	Auto	2	1500	50(80)	2"(3")	16	243	22	700	5	19.6

- > A: Automatic
- > Key or USA float switch are available to choose

EUS-Series Dimensions

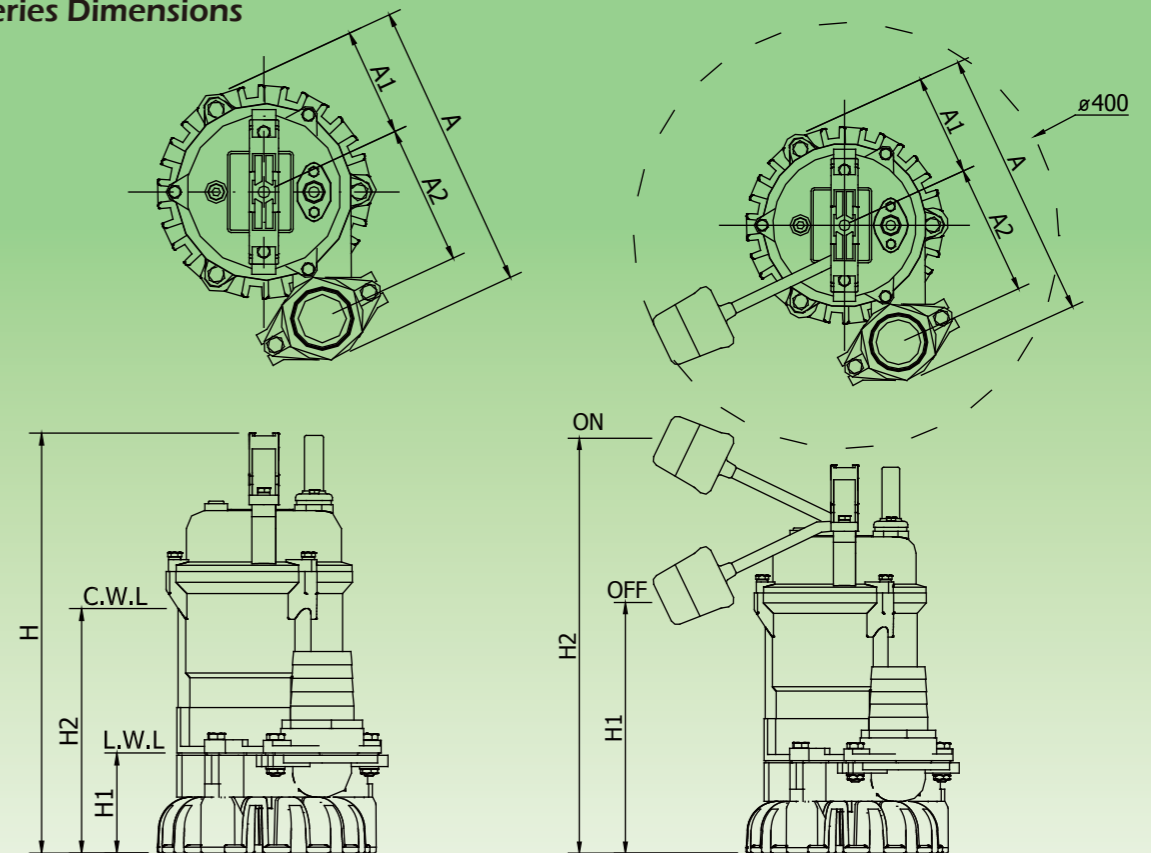

Type	A	A1	A2	H	H1	H2
50EUS-5.05	243	94	117	352	84	200
50EUS-5.05A	243	94	117	352	200	400
50(80)EUS-5.10	279	94	133	377	84	225
50(80)EUS-5.10A	279	94	133	377	225	425
50(80)EUS-5.20	313	107	155	446	94	308
50(80)EUS-5.20A	313	107	155	446	294	494

All technical information is subject to change without notice.